

ABBINK × DE HAAS
architectures

EMBRACE



elements



inside



covered

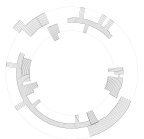

outside



routing



programme



- 1 guidance and information
- 2 entrance Central Village
- 3 reception and Wildlife shop
- 4 storage and
- 5 book lounge
- 6 bar and kitchen
- 7 cafe and restaurant
- 8 terrace
- 9 lounge deck
- 10 lockers
- 11 toilets and changing rooms
- 12 covered changing room
- 13 multimedia and expo
- 14 indoor learning and play area
- 15 tables
- 16 seating
- 17 amphibian and rental facilities
- 18 outside theatre
- 19 podium and stage
- 20 Wolves hall extension
- 21 entrance science village
- 22 Wolves hall
- 23 Study and bird watching point
- 24 rotary shear walls
- 25 toilets and storage
- 26 covered study/meeting point
- 27 offices

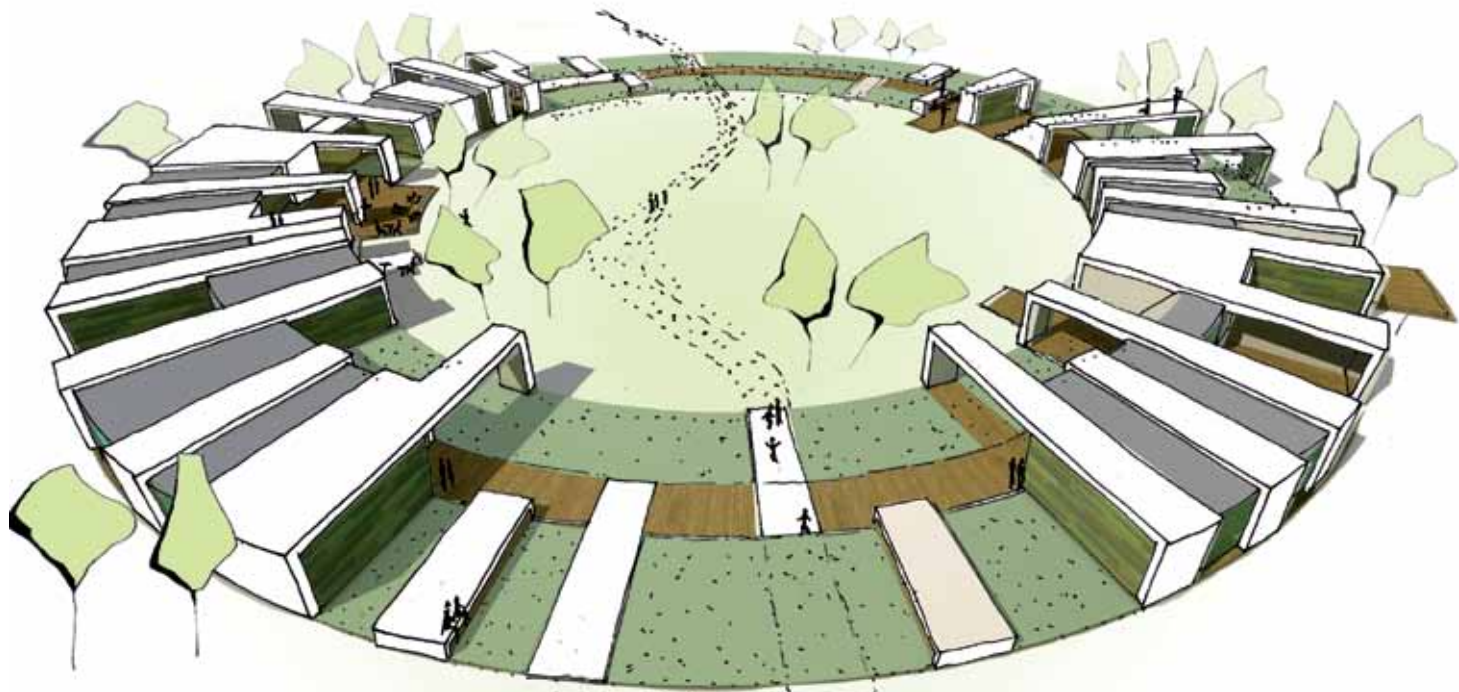



2011



2012





2014+

Embrace the differences

Even more than elsewhere, Oostvaardersplassen is graced by a special relationship between culture and nature.

The circle, perhaps the simplest form and yet the most enigmatic, is both a symbol of the ultimate “man made” perfection and also the most natural form of beauty and harmony. The circle is introduced at different levels as “the domain” of the visitors in Oostvaardersplassen. It is an autonomous element that is valued both in nature and by man.

Embrace the experience

The circles form small breaks in the wonderful nature of the Oostvaardersplassen. Between these moments, in the transition from circle to circle, the experience of the landscape is strongest and unexpected ...

Embrace the elements

Embrace is based on the Dandelion effect: how a dandelion spreads its seeds in the air. It has been deliberately chosen for its gentle spreading principle, where each separate independent element is part of a collaborative whole. The centre itself is built from repetitive elements which on the one hand work as both structure and organisation. and on the other hand forms pragmatic products to monumental objects in the landscape.

Embrace the future

With this strategy - for building and landscape - room is deliberately left for the future. The Oostvaardersplassen and the “realm of the visitors” is never ‘finished’. Room is left for the growth of this wonderful chance.



Client:

Staatsbosbeheer

Location:

Oostvaardersplassen, Lelystad

Programme:

Visitors centre

Gross area:

1000 m²

Status:

Competition July 2009

In cooperation with:

REDScape, Control Image

www.abbinkdehaas.nl

info@abbinkdehaas.nl

X