

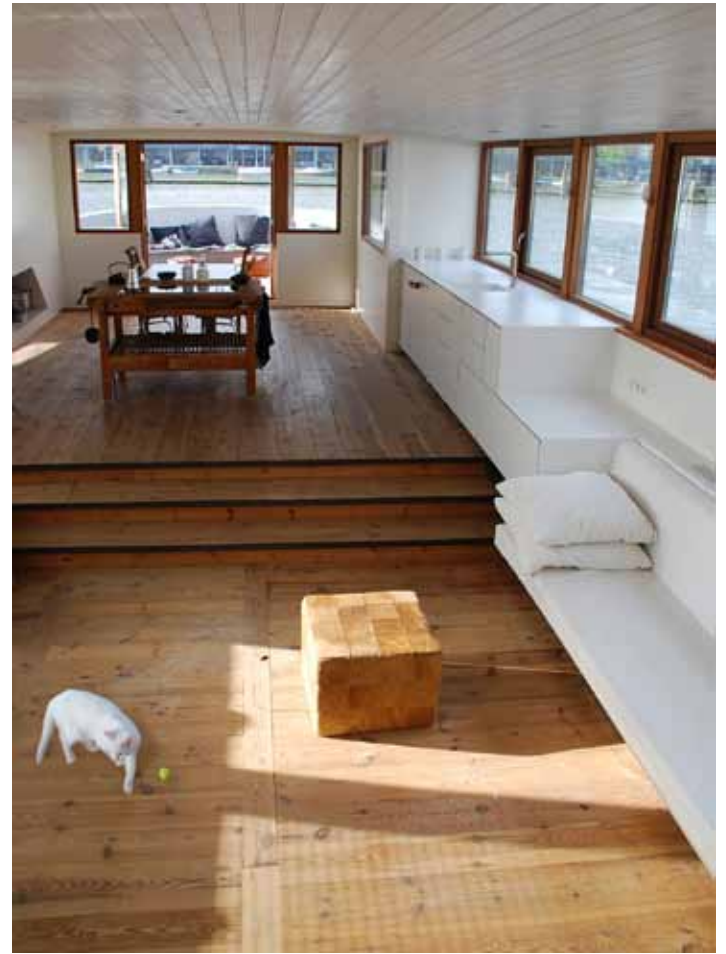

ABBINK × DE HAAS
architectures

SOMOYA



- 1 deck
- 2 bridge
- 3 vestibule
- 4 cloakroom
- 5 toilet
- 6 kitchen
- 7 living room
- 8 bedroom
- 9 bathroom
- 10 utility room
- 11 engine room
- 12 technical space
- 13 tanks
- 14 cupboard
- 15 storage
- 16 stairwell
- 17 forecastle

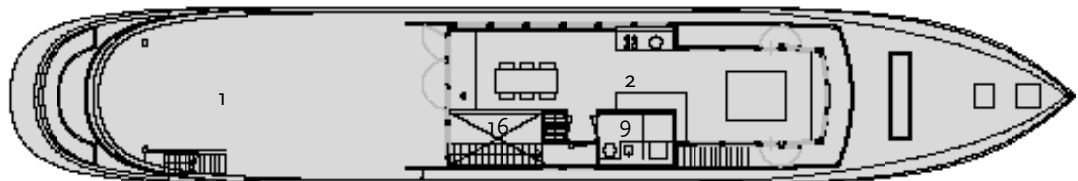

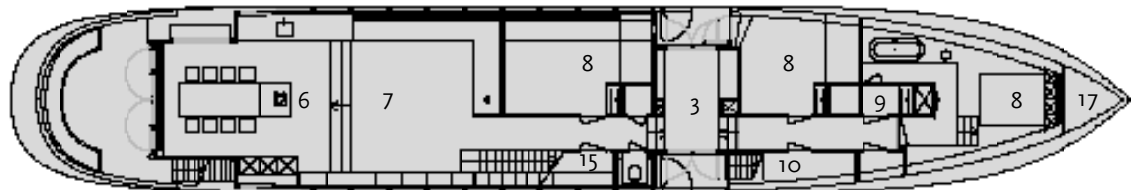



Somoya

The Somoya is the result of combining the owner's three favourite ships in one new design; the bow of a Finnish fishing inspection vessel, the stern of a Dutch maritime tugboat and the elegance of a 1950's passenger vessel from the Swiss lakes.

The main body of the ship runs from intimate bedrooms in the bow to the wide raised kitchen which opens out to the south facing stern. A busy family life, a limited budget and a large practical programme called for a simple, serene and robust design. The floors and steps are made of 80 year old untreated train wagon floor timber and trimmed with black steel. Guariuba wood and black steel details accentuate a peaceful whole. A stairwell between the two floors allows light to penetrate deep into the ship. A simple steel clad staircase leads from the atrium to the upper deck, which also has a private entrance, can be independently used as an office, Bed & Boat or a granny flat.

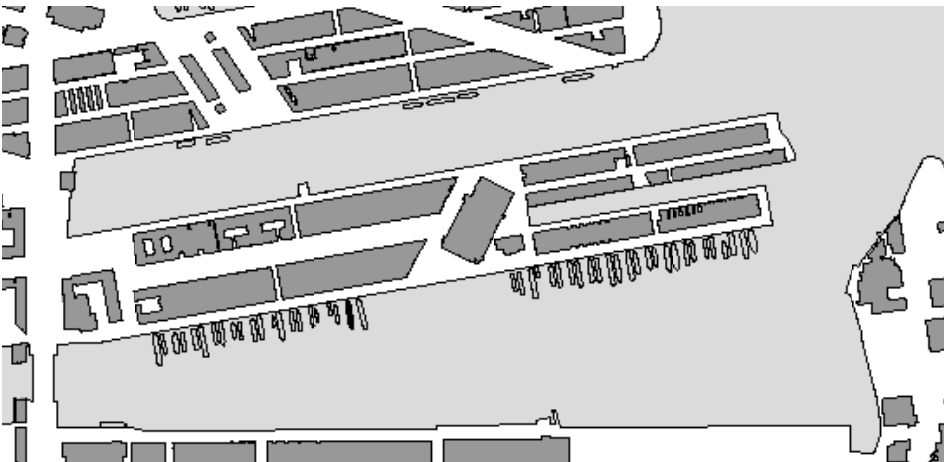

Design: Roland Stuij & Angie Abbink

Client: private

Location: Amsterdam

Length: 35.40m

Bredth: 6.00m

Height: 4.70m

Draught: 1.00m

Tonnage: 60 ton

Steel Work: Helldorfer Lasbedrijf

Building Kit: Bosgraaf Yachtdesign

Carpentry: Ventis

Status: casco completed 2005

www.abbinkdehaas.nl

info@abbinkdehaas.nl

X